

# Vismart

Intelligent Building Systems

V-ZigBee Control Smart Home Systems

## VZG-SR17

### SIREN USER MANUAL



## INTRODUCTION

Stable communication between wireless devices is important, especially in security systems. Repeater amplifies wireless signals of the security system to ensure clear communication between peripherals.

Repeater doubles as an indoor siren, sounds when an alarm is triggered by any security peripheral.

## SYSTEM PARAMETERS

VZG-SR17

Voltage: AC100-240V, DC5V with adapter

Operating Current: <210mA

Alarm Sound: ≥85dB (1m)

Operating Temperature Range: -10 °C ~ 50 °C

Zigbee Connection Range: ≤150m (open space)

Wireless Frequency: 2.4G

Operating Humidity: Max % 95 RH

Dimensions: 118x118x45mm

## DIMENSIONS AND ACCESSORIES

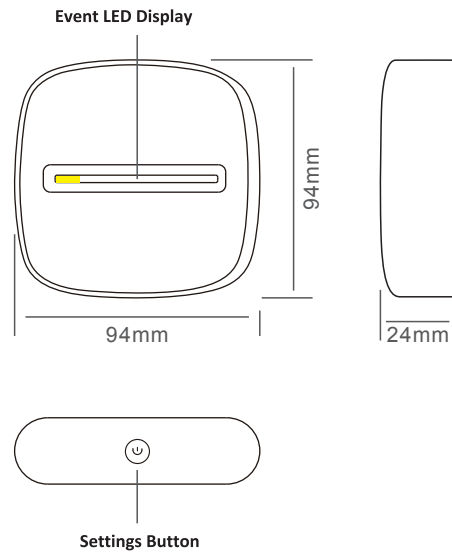

## INSTALLATION

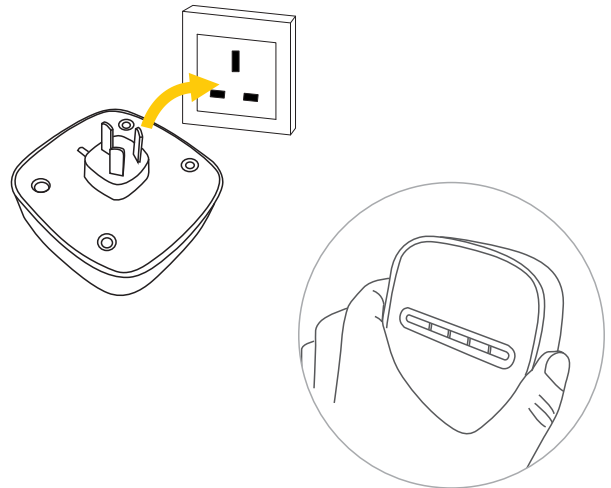

## LED LIGHT CODES

There is one settings button and two LED lights illuminating red and green. There are two working modes; User and Settings Mode

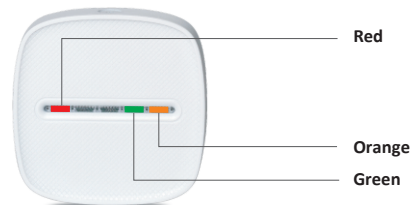

### Red Light Meanings:

1. In the User Mode; When the alarm is triggered red light will flash rapidly and alarm will sound.
2. In the User Mode; If the user set the alarm mode to 'Don't Disturb Mode', when the alarm is triggered red light will flash with 1 second intervals and alarm will not sound.
3. In the User Mode; If the red light is illuminating continuously, that indicates the alarm is armed.
4. In the User Mode; If the red light is not illuminating, that indicates the alarm is not armed.

### Green Light Meanings:

1. In the User Mode; Green light blinking shows that device is working normally.
2. In the User Mode; If you press and hold the Settings Button green light will illuminate continuously indicating that device is in Settings Mode.
3. In the Settings Mode; Flashing 5 times indicates that a wrong button input or wrong command have entered.
4. In the Settings Mode; Flashing 2 times indicates that the entered command was successful.
5. In the Settings Mode; Flashing rapidly indicates that a network connection is being made. Green light will flash 3 times after connection made successfully.

**Orange Light Meanings:**

1. Indicates that device is working normally and connected to power supply.
2. In the User Mode; If you press the Settings Button, once green light will blink once and send current status to the gateway.  
If the device is not connected green and orange light will blink 3 times simultaneously indicating that device is not connected or lost connection.

**Network Connection:**

When you plug in the device orange light will start illuminating continuously and green light will flash 3 times.

Press and hold the Settings Button for 3 seconds till the green light illuminates. When the green light illuminates press the Settings Button once (green light will blink once)

Then press and hold the Settings Button again till the green light turns on. Green light will start flashing rapidly while connecting to network. When the connection is made green light will flash 3 times indicating that connection has been made successfully.

**Note:** Before connecting this device, network connection mode should be activated on the Gateway by using the Settings Button on it.

**Factory Settings:**

Press the Settings Button for 3 seconds till the green light illuminates continuously. Then **press and release** the Settings Button 10 times (green light each pressing). Press and hold the Settings Button for 3 seconds. Green light will flash 3 times indicating that device is successfully return to factory settings.

**Note:** If you press the Settings Button more or less than 10 times green light will flash 5 times indicating that the process was unsuccessful. You can continue the process by pressing 10 times as explained above.

**Headquarter**

**VIDEOCOM-UK ELECTRONICS AND SOFTWARE LTD.**

Unit 2, Little Britain House, Alma Road, Chesham,  
Buckinghamshire, HP5 3HB London, United Kingdom

**Distributor**

**VIDEOCOM ELEKTRONIK VE BILGISAYAR SISTEMLERİ A.S.**

Ivedik OSB 1419.Cad. No:72 06370 Y.Mahalle Ankara TURKIYE

**Factory**

**SHENZHEN VIDEOCOM ELECTRONICS TECHNOLOGY CO.LTD.**

5th.Floor East 2nd.Building, Peng Teng Da Industrial Park,  
HuarongRd.Longhua, Bao an District Shenzhen CHINA